



## Sunbrite Product Gallery

COMPLETE SOLID STATE, ENERGY EFFICIENT LIGHTING SOLUTIONS

### 10mm (0.35") Single LED, Miniature Bayonet (BA9S) Base

#### Applications

- Incandescent Replacements
- Indicator Lights

#### Features/Benefits

- Large Range of Voltages Available
- Bayonet and Screw Bases Available
- Different Sized Bases Available
- Other Colors Available
- Reverse Polarity Available
- 2 Chips, Wider View Angle



[Product Gallery](#) > [Filament Lamp Replacements](#) > [10mm \(0.35"\) Single LED, Miniature Bayonet \(BA9S\) Base](#)

Part Numbers:	Emitted Color	Wavelength (nm)	Material	Unit LED Intensity mCD per die @ 20mA (If)(Typical)	Fwd. Voltage	Standard Common Pin
<a href="#">SSP-D29B9SIC-12V</a>	Super Intensity Red	636	2500	12	BA9S	1816, 181
<a href="#">SSP-D29B9SIC-28V</a>	Super Intensity Red	636	2200	28	BA9S	1843, 757
<a href="#">SSP-D29B9SIC-6V</a>	Super Intensity Red	636	2600	6	BA9S	316, 755, 47
<a href="#">SSP-D29B9SUGC-12V</a>	Super Pure Green	574	1000	12	BA9S	1816, 181
<a href="#">SSP-D29B9SUGC-28V</a>	Super Pure Green	574	950	28	BA9S	1843, 757
<a href="#">SSP-D29B9SUGC-6V</a>	Super Pure Green	562	1200	6	BA9S	316, 755, 47
<a href="#">SSP-D29B9SWC-28V</a>	Super White	-	950	28	BA9S	1843, 757
<a href="#">SSP-D29B9SYC-12V</a>	Super Yellow	590	1500	12	BA9S	1816, 181
<a href="#">SSP-D29B9SYC-28V</a>	Super Yellow	590	380	28	BA9S	1843, 757
<a href="#">SSP-D29B9SYC-6V</a>	Super Yellow	590	1700	6	BA9S	316, 755, 47

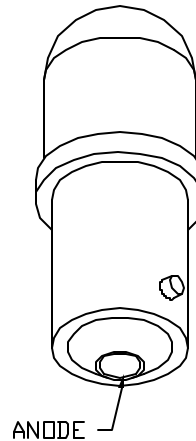
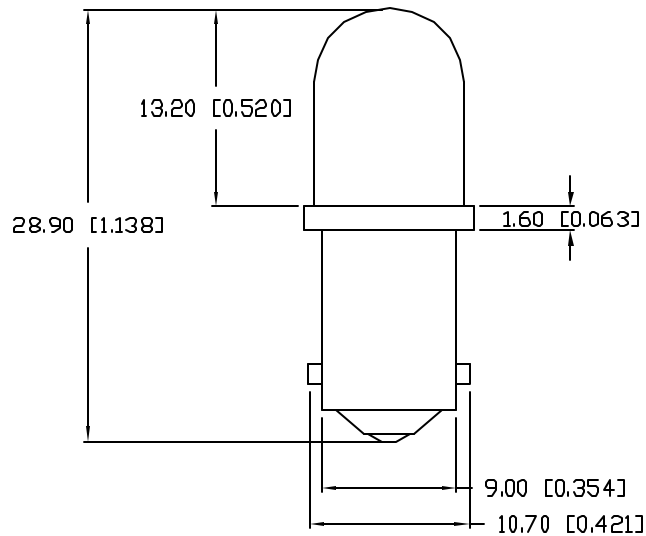
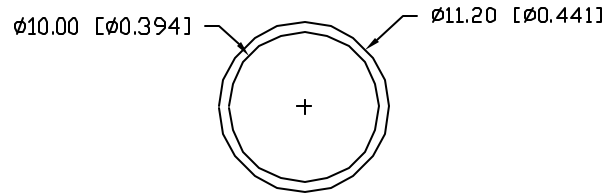

ELECTRO-OPTICAL CHARACTERISTICS  $T_A=25^{\circ}\text{C}$   $V_f=6\text{ V}$

PARAMETER	MIN	TYP	MAX	UNITS	TEST COND
PEAK WAVELENGTH		590		nm	
FORWARD VOLTAGE		6.0		$V_f$	
REVERSE VOLTAGE	5.0			$V_r$	$I_f=100\mu\text{A}$
AXIAL INTENSITY		1500		mcad	$V_f=6\text{ V}$
VIEWING ANGLE		40		2x theta	
EMITTED COLOR:	RED				
EPOXY LENS FINISH:	WATER CLEAR				

LIMITS OF SAFE OPERATION AT  $25^{\circ}\text{C}$

PARAMETER	MAX	UNITS
PEAK FORWARD CURRENT*	150	mA
STEADY CURRENT	25	mA
POWER DISSIPATION	150	mW
DERATE FROM $25^{\circ}\text{C}$	-1.2	mW/ $^{\circ}\text{C}$
OPERATING, STORAGE TEMP.	-40 TO +85	$^{\circ}\text{C}$
SOLDERING TEMP.	+260	$^{\circ}\text{C}$
2.0mm FROM BODY		3 SEC. MAX

\*  $t < 10\mu\text{s}$

\*UNLESS OTHERWISE SPECIFIED TOLERANCES PER DECIMAL PRECISION ARE: X=±1 (±0.039), X.X=±0.5 (±0.020), X.XX=±0.25 (±0.010), X.XXX=±0.127 (±0.005), LEAD SIZE=±0.05 (±0.002), LEAD LENGTH=±0.75 (±0.030), MIN= <sup>+DECIMAL PRECISION</sup> -0.00 MAX= <sup>+0.00</sup> -DECIMAL PRECISION

REV.

PART NUMBER

SSP-D29B9SYC-6V

CONFIDENTIAL INFORMATION

THE INFORMATION CONTAINED IN THIS DOCUMENT IS THE PROPERTY OF SUNBRITE LEDS. EXCEPT AS SPECIFICALLY AUTHORIZED IN WRITING BY SUNBRITE LEDS, THE HOLDER OF THIS DOCUMENT SHALL KEEP ALL INFORMATION CONTAINED HEREIN CONFIDENTIAL AND SHALL PROTECT SAME IN WHOLE OR IN PART FROM DISCLOSURE AND DISSEMINATION TO ALL THIRD PARTIES.

RELIABILITY NOTE

DUR MANY YEARS OF EXPERIENCE DATA ACCUMULATION INDICATE THAT SOLDER HEAT IS A MAJOR CAUSE OF EARLY AND FUTURE FAILURE. PLEASE PAY ATTENTION TO YOUR SOLDERING PROCESS.



10mm CIRCULAR BA9 BASE LAMP,  
590nm AlInGaP YELLOW LED, WATER CLEAR LENS.

DRAWN:  
BC

CHECKED:

APPROVED:

DATE:  
PAGE: 1 OF 1